



Power relay series pursuing reliability and safety

■ Currently it is used for such purposes

- Vending machines, Telecommunications equipment,
Disaster prevention equipment, Copiers
 - Commercial equipment, Measuring instruments, Medical devices
 - Various household appliances
-

DEC is a professional manufacturer of relays

DEC Daiichi Electric Co., Ltd.
<https://www.j-dec.co.jp>

CJ series

■ Features

- General purpose miniature power relay boasting high reliability and achievement.
- PCB type, cubic type 1 pole type relay.

■ Model numbering system

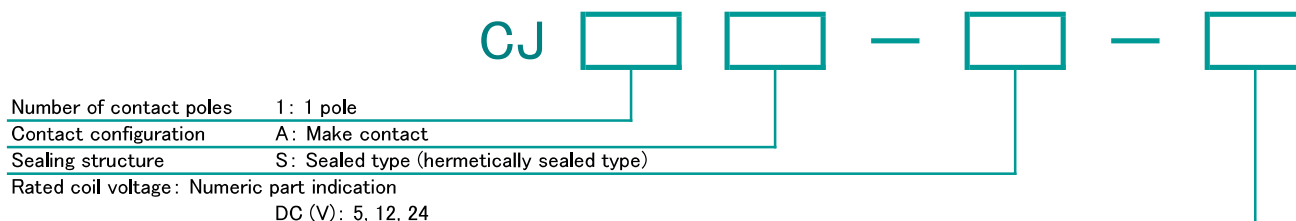

■ Safety standards

	Contact rating
UL (C-UL)	12A 240V AC
VDE	12A 240V AC
CQC	12A 240V AC

- Notes: The above safety standards are scheduled to be acquired.

■ Coil ratings

Item		Rated current (mA)	Coil resistance (Ω)	Operate voltage (V)	Release voltage (V)	Maximum voltage (V)	Power consumption (W)
AC/DC	Voltage			Ratio to rated voltage			
DC	5	71.4	69	75% max.	5% min.	110%	0.36
	12	30	400				
	24	15	1600				

- Notes: 1. Rated current and coil resistance are values at coil temperature of 20°C, tolerance is ±10%.
- 2. Operate voltage and release voltage are values at coil temperature of 20°C.
- 3. Maximum voltage is the maximum value of the allowable voltage fluctuation range of the relay coil operating power supply with the ambient temperature at 20°C.

CJ series

■ Ratings・Performance

Specifications	Item		Performance
Contact specification	Contact configuration		1a
	Contact resistance		100m Ω max. (at DC6V 1A)
	Contact material		Ag alloy
Ratings	Rated load (resistive load)		AC250V 10A
	Max. switching capacity (resistive load)		2500VA
	Max. switching voltage		AC250V
	Max. switching current		10A
Electrical capability	Insulation resistance		100M Ω min. (at DC500V)
	Dielectric strength	Between coil and contact	AC1500V 1 min
		Between open contact	AC750V 1 min
	Operate time (at rated voltage on, at 20°C)		10ms max. (excluding contact bounce time)
	Release time (at rated voltage off, at 20°C)		5ms max. (excluding contact bounce time)
Mechanical capability	Vibration resistance	Malfunction	10 to 55 to 10Hz (double amplitude 1.5mm)
		Destruction	10 to 55 to 10Hz (double amplitude 1.5mm)
	Shock resistance	Malfunction	100m/s ²
		Destruction	1000m/s ²
Life	Mechanical endurance (at 180 times/min)		1 000 000 times min.
	Electrical endurance (resistive load) (at 6 times/min)		100 000 times min. (at rated load)
Conditions for operation	Ambient temperature		-20°C to +60°C (no freezing and condensing at low temperature)
	Ambient humidity		5% to 85%RH
Mass			approx. 13g

● Notes: The above is the initial value.

■ Dimensions

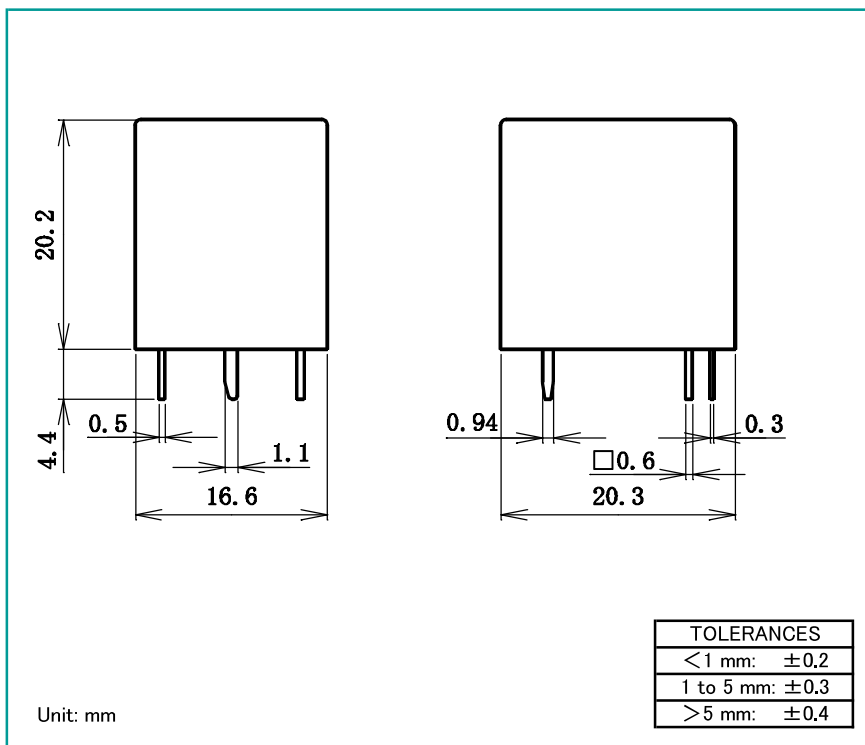

■ Schematics

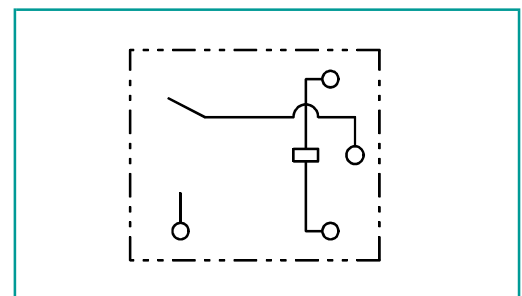

■ PCB mounting holes (tolerances ±0.1)

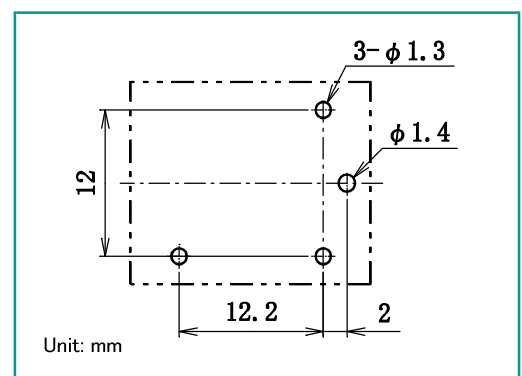

DEC is a professional manufacturer of relays

DEC Daiichi Electric Co., Ltd.
<https://www.j-dec.co.jp>

CJ series

Reference data

■ Maximum switching capacity

CJ1U

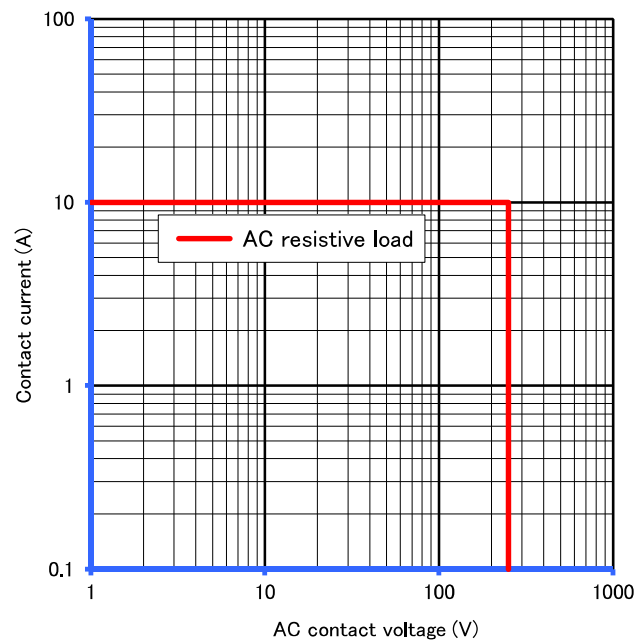

● Please understand that specifications may be changed without notice due to product improvement etc. ● Dimensions and specifications indicate only major points. Please contact our sales representatives for details.

DEC is a professional manufacturer of relays

DEC Daiichi Electric Co., Ltd.

Head office 2-2, Noge 3-chome, Setagaya-ku, Tokyo 158-0092, Japan

Phone +81-3-3703-5421

Facsimile +81-3-3703-5426

U R L <https://www.j-dec.co.jp> E-Mail: sales@j-dec.co.jp

Agency

202211