

CAST STEEL SWING CHECK VALVES ASME CLASS 300

SIZE 2" to 24"
Flanged and Butt weld Ends
Bolted Cover Type.
R.F. End Type. Fig. No. C4440
R.J. End Type. Fig. No. C4470
B.W. End Type. Fig. No. C4430

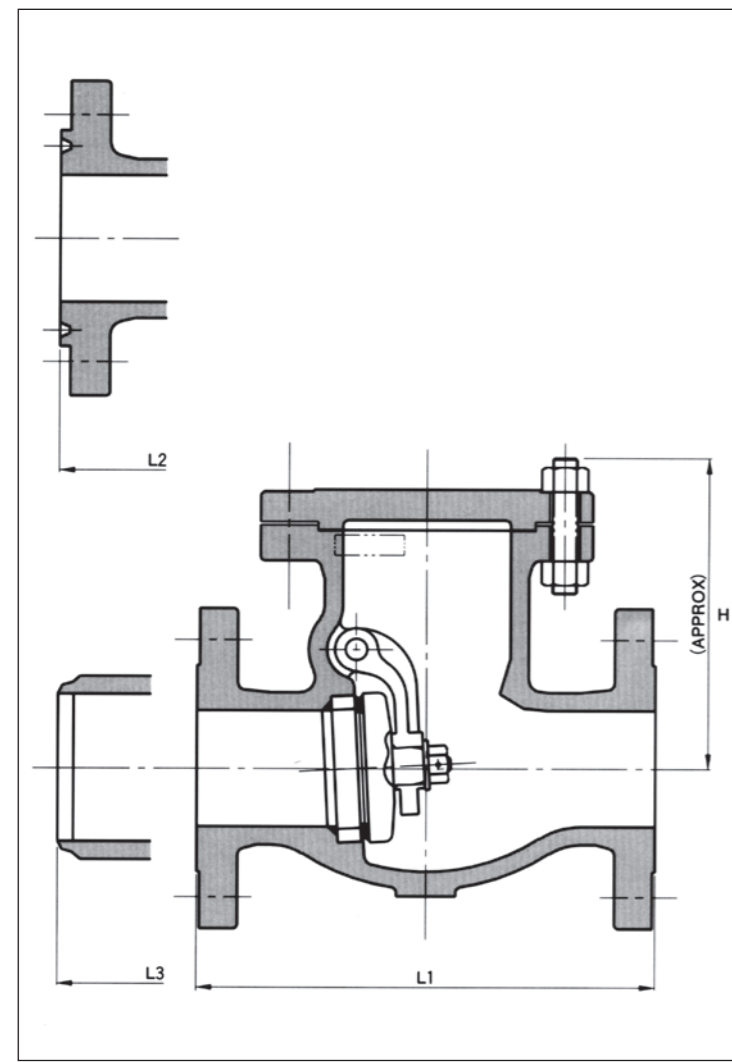

PRESSURE TEST: As per API 598

MATERIAL		
NAME OF PART	ASTM	JIS
BODY	A216 WCB	SCPH2
BODY SEAT RING	* A105	* SFVC2A
DISC	4" & UNDER	* A105
	6" & OVER	* A216 WCB
HINGE	A216 WCB	SCPH2
HINGE PIN	A276 410/420	SUS403
COVER	A216 WCB	SCPH2
COVER BOLT	A193 B7	SNB7
COVER BOLT NUT	A194 2H	S45C
COVER GASKET	SPIRAL WOUND GRAPHOIL	
KNOCK PIN	A276 304	SUS304
DISC NUT	A276 410/420	SUS403
DISC WASHER	A276 410/420	SUS403
PLUG	A276 410/420	SUS403
NAME PLATE	B209M	ALP
PLUG GASKET	A576	MILD STEEL

* BODY SEAT RING: STELLITE FACE
 * DISC: 13Cr FACE

Note: (1) Valves 6 inch and over are equipped with eye-bolts.(Mild Steel)

WEIGHT AND DIMENSIONS

Valve Size		2"	2½"	3"	4"	6"	8"	10"	12"	14"	16"	18"	20"	24"
End to End (mm)	R.F. L1	267	292	318	356	444	533	622	711	838	864	978	1016	1346
	R.J. L2	283	308	333	371	460	549	638	727	854	879	994	1035	1368
	B.W. L3	267	292	318	356	444	533	622	711	838	864	978	1016	1346
Center to Top (mm)	H	181	202	219	282	332	391	427	481	513	655	679	703	843
Weight Approx.(kg)	R.F.	30	49	54	76.5	143	220	343	468	665	840	1095	1283	2200
	R.J.	30	49	54	76.5	143	220	343	468	665	840	1095	1283	2200
	B.W.	26	39	50	60	120	195	290	350	565	715	930	1100	1870

CAST STEEL SWING CHECK VALVES ASME CLASS 600

SIZE 2" to 20"
Flanged and Butt weld Ends
Bolted Cover Type.
R.F. End Type. Fig. No. C4640
R.J. End Type. Fig. No. C4670
B.W. End Type. Fig. No. C4630

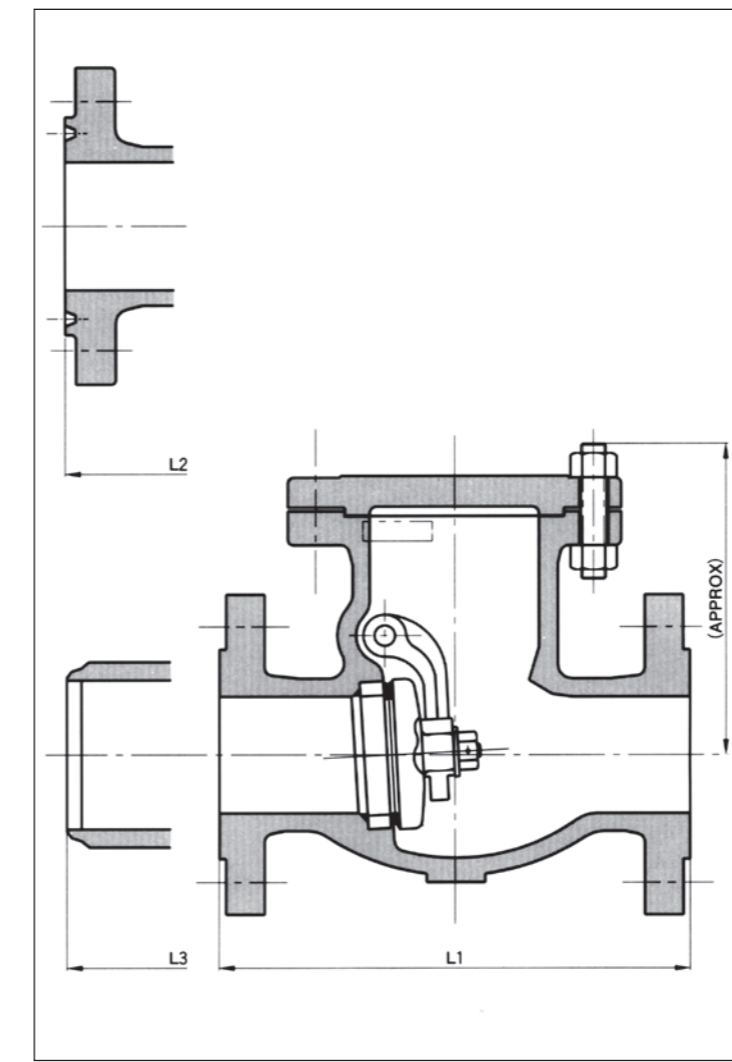

PRESSURE TEST: As per API 598

MATERIAL		
NAME OF PART	ASTM	JIS
BODY	A216 WCB	SCPH2
BODY SEAT RING	* A105	* SFVC2A
DISC	4" & UNDER	* A105
	6" & OVER	* A216 WCB
HINGE	A216 WCB	SCPH2
HINGE PIN	A276 410/420	SUS403
COVER	A216 WCB	SCPH2
COVER BOLT	A193 B7	SNB7
COVER BOLT NUT	A194 2H	S45C
COVER GASKET	SPIRAL WOUND GRAPHOIL	
KNOCK PIN	A276 304	SUS304
DISC NUT	A276 410/420	SUS403
DISC WASHER	A276 410/420	SUS403
PLUG	A276 410/420	SUS403
NAME PLATE	B209M	ALP
PLUG GASKET	A576	MILD STEEL

* BODY SEAT RING: STELLITE FACE
 * DISC: 13Cr FACE

Note: (1) Valves 6 inch and over are equipped with eye-bolts.(Mild Steel)

WEIGHT AND DIMENSIONS

Valve Size		2"	2½"	3"	4"	6"	8"	10"	12"	14"	16"	18"	20"
End to End (mm)	R.F. L1	292	330	356	432	559	660	787	838	889	991	1092	1194
	R.J. L2	295	333	359	435	562	664	791	841	892	994	1095	1200
	B.W. L3	292	330	356	432	559	660	787	838	889	991	1092	1194
Center to Top (mm)	H	181	202	219	282	332	391	427	481	513	655	679	703
Weight Approx.(kg)	R.F.	38	55	63	116	212	310	590	800	1110	1500	2000	2600
	R.J.	45	55	64	116	201	369	590	800	1110	1500	2000	2600
	B.W.	34	42	50	85	167	281	430	620	940	1250	1700	2200